

- Alness Drive
Woodthorpe, York
YO24 2XZ

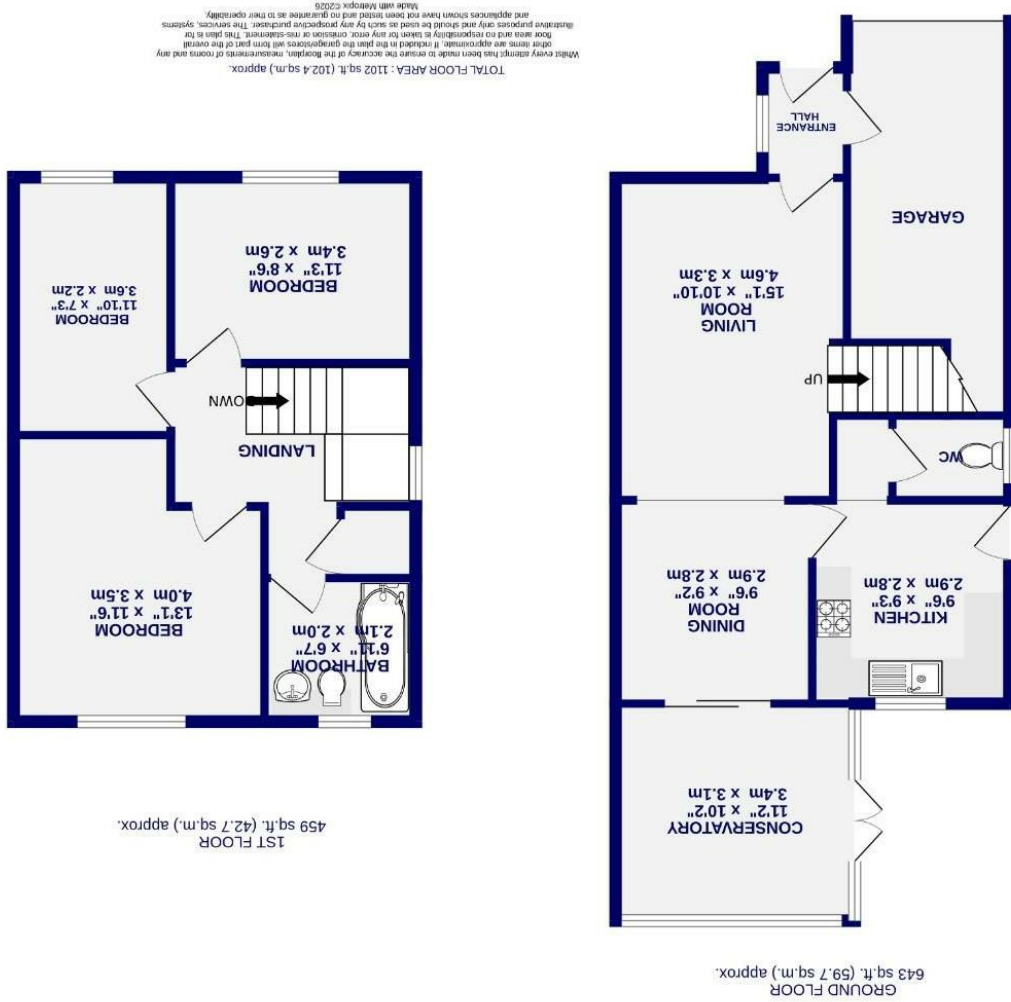

Alness Drive
Woodthorpe, York
YO24 2XZ

£395,000

 3  1

Located in the popular residential area of Woodthorpe, to the south of York, is this well-presented three-bedroom detached home, occupying a desirable plot with landscaped gardens and a private rear aspect. The property is ideally positioned within close proximity to a range of local amenities, including schools, shops and everyday conveniences, making it well suited to families and professionals alike.

Internally, the accommodation begins with a welcoming entrance hall which leads through to a spacious open-plan living and dining area. Dual aspect windows to the front and rear allow natural light to flood the space, creating a bright and inviting setting for both relaxing and entertaining. Beyond this is a generous conservatory, enjoying pleasant views over the landscaped garden and benefiting from French doors opening onto an immaculate decked area. Completing the ground floor is a fitted kitchen offering a good range of wall and base units, a convenient cloakroom, and internal access to the integral garage.

To the first floor are three well-proportioned bedrooms, served by a generous landing and a contemporary three-piece family bathroom.

Externally, the property provides ample driveway parking to the front, while the east-facing rear garden has been thoughtfully landscaped for low maintenance, featuring decking and gravelled areas, all enclosed by fenced boundaries and complemented by a pretty, tree-lined backdrop beyond.

Offered with no onward chain, this attractive home represents an excellent opportunity and early viewing is highly recommended.

Council Tax Band D

